



SPLINED HUBS FOR HYDRAULIC PUMPS, MOTORS & TRACTORS

PRECISION SPLINED HUBS



SPLINED HUBS are manufactured from K1045 Carbon Steel. O.D. is machined true to spline axis after broaching. All items are supplied in soft condition and may be induction or case hardened. Hub outside diameter reflects a tolerance of - 0.000" + 0.001". Length tolerance is + or - 0.030". Welding operations should be carried out using a low hydrogen electrode. For best results use a stainless steel electrode such as STAINCRAFT (CIG). Preheat parts to 200°C temp before welding.

Number of Teeth	Nom Spline O.D.	Specifications of Spline	Origin or Standard	Hub Length	Hub Diameter	Known uses for this Hub	Part Number
6	1"	6B STRAIGHT SAE	IMP. ANSI	1.75"	2.000"	HYD. ORBIT MOTORS	94/50005
6	1 3/8"	6B STRAIGHT SAE	IMP. ANSI	2.50"	2.500"	AG. TRACTOR P.T.O.	94/50033
9	5/8"	16/32 DP INV CL 5	IMP. ANSI	1.25"	1.250"	HYD. SAE A SPLINE	94/50001
8	36mm	8T STRAIGHT 32x36	DIN 5462	2.00"	2.250"	TRUCK P.T.O - Etc	94/500115
10	1 3/4"	10B STRAIGHT SAE	IMP. ANSI	2.25"	3.000"	DRIVELINE - SPICER	94/50081
11	3/4"	16/32 DP INV CL 5	IMP. ANSI	1.50"	1.500"	HYD.SAE A HD SPLINE	94/50002
12	13/16"	16/32 DP INV CL 5	IMP. ANSI	1.50"	1.500"	HYD. ORBITAL ETC.	94/50034
13	7/8"	16/32 DP INV CL 5	IMP. ANSI	1.50"	1.500"	HYD. SAE B SPLINE	94/50003
13	1 3/4"	8/16 DP INV CL 5	IMP. ANSI	2.25"	3.000"	HYD. SAE D/E SPLINE	94/50008
14	20mm	1.25 MODULE INV	DIN 5480	1.50"	1.500"	HYD. REXROTH ETC	94/50035
14	1 1/4"	12/24 DP INV CL 5	IMP. ANSI	2.00"	2.250"	HYD.SAE C SPLINE	94/50006
14	30mm	2 MODULE INV	DIN 5480	2.00"	2.250"	HYD. REXROTH ETC	94/50010
14	1 1/2"	10/20 DP INV CL 5	IMP. ANSI	2.25"	2.250"	GENERAL APPLICATIONS	94/50036
14	2 1/2"	6/12 DP INV CL 5	IMP. ANSI	3.25"	4.000"	GENERAL APPLICATIONS	94/500133
15	1"	16/32 DP INV CL 5	IMP. ANSI	1.75"	1.750"	HYD. SAE BB SPLINE	94/50004
15	2"	8/16 DP INV CL 5	IMP. ANSI	3.00"	3.250"	HYD. SAE F SPLINE	94/50037
16	30mm	A 30 x 27	DIN 5482	2.00"	2.000"	LINDE HYD. PUMPS	94/50068
16	35mm	2 MODULE INV	DIN 5480	2.00"	2.250"	HYD. REXROTH ETC	94/50011
16	1.7"	10/20 DP INV CL 5	IMP. ANSI	2.25"	2.750"	GENERAL APPLICATIONS	94/50039
16	2 1/8"	8/16 DP INV CL 5	IMP. ANSI	2.95"	3.500"	HYD. ORBIT MOTORS	94/50040
17	1 1/8"	16/32 DP INV CL 5	IMP. ANSI	2.00"	2.250"	GENERAL APPLICATIONS	94/50027
17	1 1/2"	12/24 DP INV CL 5	IMP. ANSI	2.25"	2.500"	HYD. SAE CC SPLINE	94/50032
18	25mm	1.25 MODULE INV	DIN 5480	1.75"	1.750"	REXROTH	94/50020
18	25mm	1.25 MODULE INV	DIN 5480	1.75"	1.750"	KUBOTA	94/50020K
18	35mm	A35 x 31	DIN 5482	2.12"	2.250"	GENERAL APPLICATIONS	94/50021
18	40mm	2 MODULE INV	DIN 5480	2.25"	3.000"	HYD. REXROTH ETC	94/50041
19	1 1/4"	16/32 DP INV CL 5	IMP. ANSI	2.00"	2.500"	GENERAL APPLICATIONS	94/50069
20	3 1/2"	6/12 DP INV CL5	IMP. ANSI	3.25"	5.000"	STAFFA SHAFT	94/500137
21	1 3/8"	16/32 DP INV CL 5	IMP. ANSI	2.12"	2.250"	HYD. SUNDSTRAND, EATON	94/50007
21	45mm	2 MODULE INV	DIN 5480	2.25"	3.000"	HYD. REXROTH ETC	94/50042
22	70mm	3 MODULE INV	DIN 5480	2.50"	4.500"	STAFFA Z SHAFT	94/500127
23	1 1/2"	16/32 DP INV CL 5	IMP. ANSI	2.12"	2.250"	HYD.SUNDSTRAND.EATON	94/50043
23	48mm	A48 x 44	DIN 5482	2.75"	3.000"	GENERAL APPLICATIONS	94/50044
24	50mm	2 MODULE INV	DIN 5480	2.75"	3.250"	HYD.REXROTH ETC	94/50045
26	1.4"	20/40 DP INV CL 5	IMP. ANSI	2.00"	2.000"	MARINE TRANSMISSIONS	94/50046
26	55mm	2 MODULE INV	DIN 5480	2.75"	3.250"	GENERAL APPLICATIONS	94/50047
26	2 1/4"	12/24 DP INV CL 5	IMP. ANSI	3.00"	3.250"	GENERAL APPLICATIONS	94/50048
27	1 3/4"	16/32 DP INV CL 5	IMP. ANSI	2.12"	3.000"	HYD.SUNDSTRAND.EATON	94/50009
40	2 9/16"	16/32 DP INV CL 5	IMP. ANSI	2.37"	3.375"	HYD.SUNDSTRAND.EATON	94/50049

METRIC SPLINES TO DIN STANDARD

When ordering metric splines to DIN standard, the following criteria will be required.

W35 X 2 X 30 X 16 X 9G

Spline Dia
Module
Pressure Angle
No of teeth
Fit



SPLINE DETAILS. Female involute splines listed in this catalogue are fillet root side fit. They may be used with flat root fit shafts.

Imperial involute splines are to ANSI B92.1-1970 Class 5. On ANSI splines actual O.D. of mating shaft may be smaller than shown as nominal spline O.D. to allow for root clearance.

Metric involute splines listed are to DEUTSCHE NORMEN DIN 5480, DIN 5482 or DIN 5462.



SPLINED COUPLINGS



SPLINED COUPLINGS are manufactured from K1045 Carbon steel. They are intended for joining two splined shafts together and the outside diameter of the coupling cannot be guaranteed to be true to the axis of the spline. Couplings have thin wall, take care if welding.

Number of Teeth	Nom Spline O.D.	Specifications of Spline	Origin or Standard	Coupling Length	Coupling Diameter	Known uses for this Coupling	Part Number
6	3/4"	6B STRAIGHT SAE	IMP.	2.5"	1 3/8"	MOBILE EQUIPMENT	94/600100
6	7/8"	6B STRAIGHT SAE	IMP.	2.5"	1 3/8"	MOBILE EQUIPMENT	94/600101
6	1"	6B STRAIGHT SAE	IMP.	2.75"	1 3/8"	MOBILE EQUIPMENT	94/600005
6	1 1/8"	6B STRAIGHT SAE	IMP.	2.75"	1 9/16"	MOBILE EQUIPMENT	94/600102
6	1 1/4"	6B STRAIGHT SAE	IMP.	3.25"	1 7/8"	MOBILE EQUIPMENT	94/600082
6	34mm	DIN 5463 6 x 28 x 34	DIN.	80mm	50mm	SAI MOTORS	94/600114
6	1 3/8"	6B STRAIGHT SAE	IMP.	3.75"	1 3/4"	AG TRACTOR P.T.O.'s	94/60033
6	1 3/8"	6B STRAIGHT SAE	IMP.	6"	1 3/4"	AG TRACTOR P.T.O.'s	94/60033L
6	1 1/2"	6B STRAIGHT SAE	IMP.	3.75"	1 7/8"	MOBILE EQUIPMENT	94/600104
6	1 5/8"	6B STRAIGHT SAE	IMP.	3.75"	2"	MOBILE EQUIPMENT	94/600105
6	1 3/4"	6B STRAIGHT SAE	IMP.	3.75"	2 1/8"	MOBILE EQUIPMENT	94/600083
9	5/8"	16/32 DP INV CL 5	IMP.	2"	1 3/8"	HYD. SAE A SPLINE	94/600001
10	25mm	METRIC INV	DIN.	2.75"	1 3/8"	KUBOTA ETC	94/600107
10	1"	10B STRAIGHT SAE	IMP.	2.5"	1 3/8"	MOBILE EQUIPMENT	94/600108
10	1 1/32"	10B STRAIGHT SAE	IMP.	3.25"	1 1/2"	MOBILE EQUIPMENT	94/600123
10	1 1/8"	10B STRAIGHT SAE	IMP.	3.25"	1 1/2"	MOBILE EQUIPMENT	94/600109
10	1 1/4"	10B STRAIGHT SAE	IMP.	3.75"	1 3/4"	MOBILE EQUIPMENT	94/600110
10	1 3/8"	10B STRAIGHT SAE	IMP.	3"	1 3/4"	MOBILE EQUIPMENT	94/600111
10	1 1/2"	10B STRAIGHT SAE	IMP.	3"	1 7/8"	MOBILE EQUIPMENT	94/600112
11	3/4"	16/32 DP INV CL 5	IMP.	2"	1 3/8"	HYD. SAE A HD SPL	94/600002
13	7/8"	16/32 DP INV CL 5	IMP.	2"	1 3/8"	HYD. SAE B SPLINE	94/600003
13	7/8"	16/32 DP INV CL 5	IMP.	3"	1 3/8"	HYD. SAE B SPLINE	94/60003L
13	1 3/4"	8/16 DP INV CL 5	IMP.	3.75"	2 1/4"	HYD. SAE D/E SPLINE	94/600008
14	1 1/4"	12/24 DP INV CL 5	IMP.	3"	1 3/4"	HYD. SAE C SPLINE	94/600006
15	1"	16/32 DP INV CL 5	IMP.	3"	1 1/2"	HYD. SAE BB SPLINE	94/600004
20	1 3/4"	12/24 DP INV CL 5	IMP.	3"	2 1/4"	AG TRACTOR P.T.O.'s	94/600113S
20	1 3/4"	12/24 DP INV CL 5	IMP.	3.75"	2 1/4"	AG TRACTOR P.T.O.'s	94/600113
21	1 3/8"	16/32 DP INV CL 5	IMP.	3"	1 3/4"	AG TRACTOR P.T.O.'s	94/600007
21	1 3/8"	16/32 DP INV CL 5	IMP.	6"	1 3/4"	AG TRACTOR P.T.O.'s	94/60007L
23	1 1/2"	16/32 DP INV CL 5	IMP.	3"	2"	HYD SUNDSTRAND	94/600043
27	1 3/4"	16/32 DP INV CL 5	IMP.	3"	2 1/4"	HYD AND AG.	94/600009



SPLINED SHAFTING & NIB SHAFTS FOR HYDRAULICS, OFF-ROAD & AGRICULTURAL

STANDARD SPLINED SHAFTING



Splined shafting is hobbled for the full listed length. In some instances undercut chucking registers may be present at one end. A centre is provided at one end. Material is K1045 Carbon steel. Finish is black oxide rust preventative. Imperial involute splines are to ANSI B92.1-1970. Pressure angles on all involute splines listed are 30 degrees. Spline OD* as listed for shafting, stubwelds and nibs is the form diameter. Actual major diameter may be smaller than form diameter by the form clearance for the subject spline. Straight sided splines are all to SAE standard.

Number of Teeth	Nom Spline O.D.*	Specifications of Spline	Origin or Standard	Shaft Length	Known uses for this Hub	Part Number
6	1"	STRAIGHT SAE	IMP	8"	MOBILE EQUIP	94/70005S
6	1"	STRAIGHT SAE	IMP	10"	MOBILE EQUIP	94/70005
6	1 1/8"	STRAIGHT SAE	IMP	10"	AGRICULTURE	94/700102
6	1 1/4"	STRAIGHT SAE	IMP	8"	MOBILE EQUIP	94/70082
6	34mm	34 x 28	DIN 5463	8"	AGRICULTURE	94/700114
6	1 3/8"	STRAIGHT SAE	IMP	8"	AGRICULTURE	94/70033
6	1 1/2"	STRAIGHT SAE	IMP	10"	MOBILE EQUIP	94/700104
6	1 5/8"	STRAIGHT SAE	IMP	8"	MOBILE EQUIP	94/700105
6	1 3/4"	STRAIGHT SAE	IMP	8"	MOBILE EQUIP	94/70083
9	5/8"	16/32 DP INV 30PA	IMP. ANSI	6"	HYD. SAE A	94/70001
10	1 1/4"	STRAIGHT SAE	IMP	10"	MOBILE EQUIP	94/700110
10	1 3/4"	STRAIGHT SAE	IMP	8"	MOBILE EQUIP	94/70081
11	3/4"	16/32 DP INV 30PA	IMP. ANSI	6"	HYD. SAE AH	94/70002
13	7/8"	16/32 DP INV 30PA	IMP. ANSI	6"	HYD. SAE B	94/70003
13	1 3/4"	8/16 DP INV 30PA	IMP. ANSI	8"	HYD. SAE D/E	94/70008
14	1 1/4"	12/24 DP INV 30PA	IMP	8"	HYD.SAE C	94/70006
14	1 1/4"	12/24 DP INV 30PA	IMP	11"	HYD.SAE C	94/70006LL #
15	1"	16/32 DP INV 30PA	IMP. ANSI	8"	HYD. SAE BB	94/70004
16	35mm	2 MODULE INV W35	DIN 5480	203mm	HYD. REXROTH	94/70011
16	1.7"	10/20 DP INV 30PA	IMP. ANSI	8"	GENERAL	94/70039
16	2 1/8"	8/16 DP INV 30PA	IMP. ANSI	8"	GENERAL	94/70040
17	1 1/2"	12/24 DP INV 30PA	IMP. ANSI	8"	GENERAL	94/70032
18	35mm	A35 x 31	DIN 5482	203mm	GENERAL	94/70021
20	1 3/4"	12/24 DP INV 30PA	IMP. ANSI	8"	AGRICULTURE	94/700113
21	1 3/8"	16/32 DP INV 30PA	IMP. ANSI	8"	AGRICULTURE	94/70007
23	1 1/2"	16/32 DP INV 30PA	IMP. ANSI	8"	HYD.SUND	94/70043
24	50mm	2 MODULE INV W50	DIN 5480	203mm	HYD. REXROTH	94/70045
26	2 1/4"	12/24 DP INV 30PA	IMP. ANSI	8"	GENERAL	94/70048
27	1 3/4"	16/32 DP INV 30PA	IMP. ANSI	8"	AGRICULTURE	94/70009
40	2 9/16"	16/32 DP INV 30PA	IMP. ANSI	8"	HYD.SUND	94/70049

SPLINED FLOATING NIB SHAFTS

Long spline area for telescoping drives or transfer drive applications. Keyed shaft end for drive attachment. Use with our standard splined hubs or splined couplings.

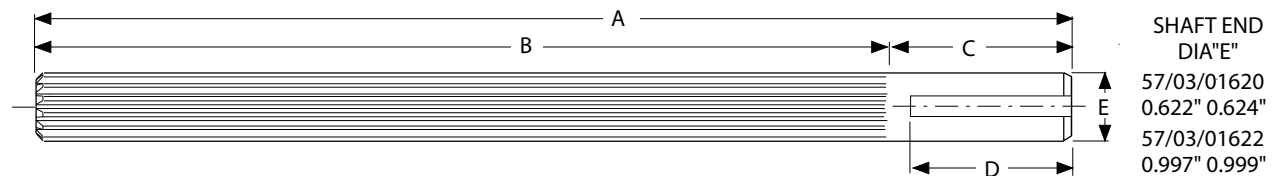

Part Number	A	B	C	D	Spline OD*	Key	No Of teeth	DP	Mating Cplgs	Mating Hubs
57/03/01620	470	410	60	40	0.625"	0.187"	9	16/32	94/60001	94/50001
57/03/01622	410	350	60	40	1.000"	0.250"	15	16/32	94/60004	94/50004

NSL Technology Resources (s) Pte Ltd
 No 280 Woodlands Industrial Park E5,
 #09-11 Harvest @ Woodlands,
 Singapore 757322
 Tel : +65 67957477, 7747 Fax : +65 63162368
 Email : sales@nsstechnology.com