



FLEXILOCK LIVE P.T.O. DRIVE KITS FOR DIESEL ENGINES

APPLICATIONS

Pulley drives, Chain drives, other applications where a male output shaft from a diesel engine is required.

FEATURES

Taper roller bearings for high capacity and long life, spheroidal graphite cast iron housing. Flexilock drive for installation ease, reduces torsional vibration transmission and misalignment capacity. Protects engine bearings and crank from side load failures. Comes factory filled with ATF oil

Kit includes : - Flexilock flywheel driveplate, Flexilock engine housing adaptor plate, bearing supported stub shaft.

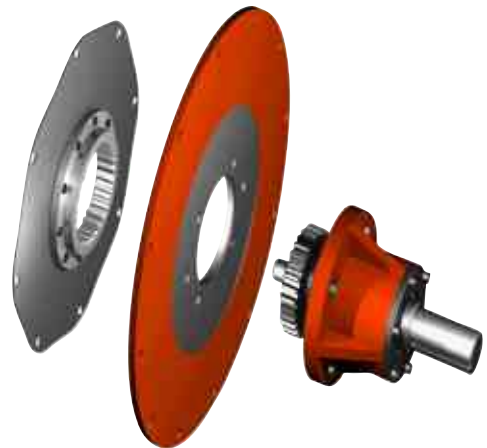

NEW - LPTO with DG style coupling for heavy duty applications
Contact our Sales Office for details.

LPTO ORDERING INFORMATION - COMMON TYPES

Warning - Do not use on water pumps with time clock shutdown, engine must be idled down before switching off, due to the possibility of water pressure inertia which may cause the coupling to fail.

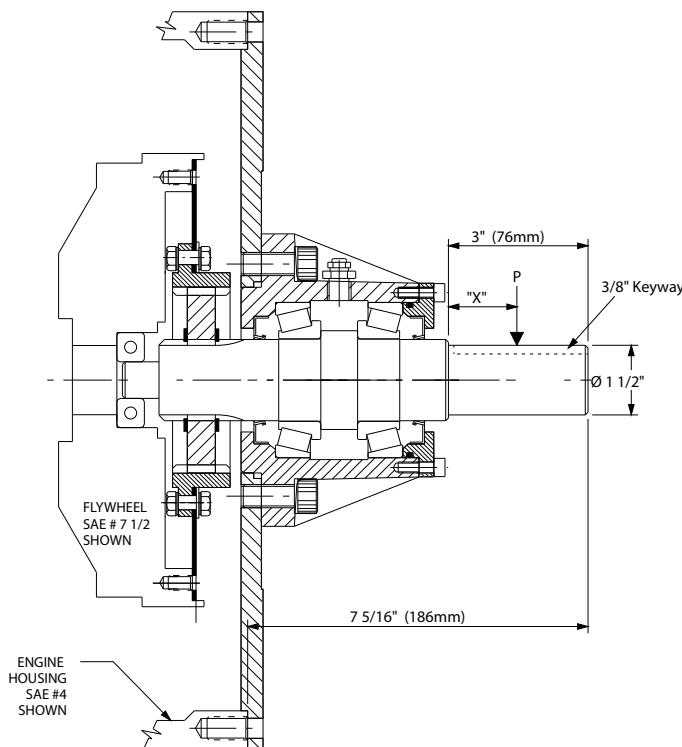

Overhung load calculation

$$P = \frac{126000 \times \text{HP}}{\text{RPM} \times d} \times K$$

where

P = load in pounds due to belt pull

HP = diesel engine power

RPM = speed

d = pulley pitch diameter inches

K = factor

1.5 for V-belts

2.5 for flat belts

$$P(\text{lbs}) \times 0.4536 = P(\text{kg})$$

Allowable side pull loads P

RPM	Distance "X"	
	25mm	50mm
1000	379 kg	283 kg
2000	302 kg	270 kg
3000	265 kg	238 kg

Flexilock Series	Engine Housing	Engine Flywheel	Power Rating	Speed RPM	LPTO Part Number	Pilot Bearing Customer Supply
101	SAE 3	11 1/2	70 HP	2600	91/P03L603	6306-2RS
101	SAE 4	10	70 HP	2800	91/K03L603	6306-2RS
101	SAE 4	8	70 HP	2800	91/J03L603	6305-2RS
101	SAE 4	7 1/2	70 HP	2800	91/H03L603	6304-2RS
101	SAE 5	7 1/2	70 HP	3000	91/E03L603	6304-2RS
101	SAE 5	6 1/2	70 HP	3000	91/D03L603	6304-2RS

Above are standard combinations. Other combinations available.
Consult our sales office.

NSL Technology Resources (s) Pte Ltd

No 280 Woodlands Industrial Park E5,

#09-11 Harvest @ Woodlands,

Singapore 757322

Tel : +65 67957477, 7747 Fax : +65 63162368

Email : sales@nsltechnology.com