

FLEXIBLE MINI SHAFT COUPLINGS

Double Crowned Tooth Gear Type With Nylon Element And Sintered Steel Hubs.



FLEXIBLE COUPLINGS & REPLACEMENT ELEMENTS

Type	no. of teeth	A	B	C	D	E	F	G	H	Basic Torque Nm*	Basic kW Per 100 RPM*	Min/Max Bore	Weight Kg
M-19	24	50	48.3	37	6.5	32	38.86	21.5	7	15.5	0.1617	10-19	0.27
M-28	34	80	65.6	46	17	44	53.85	35.5	9	44	0.4592	10-28	0.82
M-38	44	80	83.6	49	15.5	58.5	68.58	35.5	9	78.5	0.8194	12-38	1.90

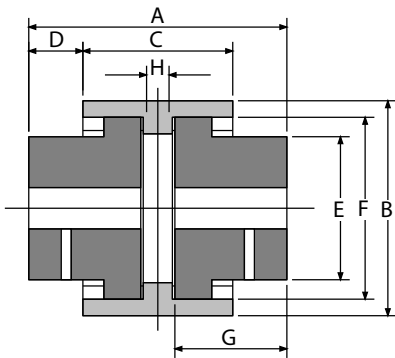

*Power And Torque Factors

Basic Power and Torque value allows for continuous use on mechanical drive equipment with moderate shock loading at full misalignment tolerance. For Hydraulic drive applications with uniform loading up to 8 hours per day with true alignment and temperature not above 82°C, basic Power and Torque values may be increased by 1.75. Maximum starting and breaking torque should not exceed two times basic torque. Intermittent, transient peak loads should not exceed three times the basic torque. Refer page 33 for service factors.

Misalignment Tolerances

Axial Displacement +/- 1 mm
 Parallel Offset 0.4 mm
 Angular Misalignment 1° Per Hub
 Axial Displacement (slip) 5 mm

Temperature Range

Continuous 82°C
 Intermittent 120°C

Part Number	M19 Series Description	Part Number	M28 Series Description	Part Number	M38 Series Description
GM19/00	Pilot bore	GM28/00	M28 Pilot bore	GM38/00	M38 Pilot bore
GM19/70	11mm x 4mm key	GM28/78	1/2" x 1/8" key	GM38/23	5/8" x 5/32" & 3/16" key
GM19/78	1/2" x 1/8" key	GM28/23	5/8" x 5/32" & 3/16" key	GM38/124	22 mm x 6 mm key
GM19/71	14mm x 5mm key	GM28/13	3/4" x 3/16" key	GM38/14	7/8" x 3/16" key
GM19/23	5/8" x 5/32" & 3/16" key	GM28/14	7/8" x 3/16" key	GM38/74	24 mm x 8 mm key
GM19/13	3/4" x 3/16" key	GM28/73	19mm x 6mm key	GM38/26	25 mm x 8 mm key
GM19/25	18mm x 6mm key	GM28/15	1" x 1/4" key	GM38/15	1" x 1/4" key
GM19/73	19mm x 6mm key	GM28/74	24mm x 8mm key	GM38/24	1 1/4" x 5/16" key
GM19/E	Nylon element	GM28/75	28mm x 8mm key	GM38/30	30mm x 8mm key
		GM28/CLA01	Spline 9T 5/8" 16/32 clamp	GM38/80	32mm x 10mm key
		GM28/CLA03	Spline 13T 7/8" 16/32 clamp	GM38/51	38mm x 10mm key
		GM28/E	Nylon element	GM38/75	28mm x 8mm key
				GM38/CLA01	Spline 9T 5/8" 16/32 clamp
				GM38/CLA02	Spline 11T 3/4" 16/32 clamp
				GM38/CLA03	Spline 13T 7/8" 16/32 clamp
				GM38/CLA04	Spline 15T 1" 16/32 clamp
				GM38/E	Nylon element

Other sizes are available contact our sales office

For larger size couplings refer Flexilock series on page 10.